

# Lift Strut/Counterbalance Application

## PRODUCT SPECIFICATIONS

Pressure Medium.....	Nitrogen Gas
Charging Pressure Range .....	Max.: 150 bar/2175 psi
	Min.: 50 bar/725 psi
Operating Temperature Range .....	-20° to +80° C/-4° to +176° F
Maximum Piston Rod Velocity.....	35 m/min
	115 ft/min
Force Variation.....	+/-0.30%/°C
	+/-0.54%/°F
Tube Surface .....	Black Oxide
Piston Rod Surface.....	Chromium Plated

## APPLICATION FORM

Company Name \_\_\_\_\_  
Address \_\_\_\_\_  
Contact Name \_\_\_\_\_ Title \_\_\_\_\_  
Telephone \_\_\_\_\_ Fax \_\_\_\_\_ E-mail \_\_\_\_\_

Application Description \_\_\_\_\_

Mounting Preference \_\_\_\_\_ Estimate of Annual Quantity Requirement \_\_\_\_\_

Space Limitations \_\_\_\_\_ Delivery Requirements \_\_\_\_\_

Include assembly drawings if possible or sketch the initial and final spring orientation relative to the installation.

### Environmental Factors

- Indoor Application
- Vibration Effects
- Corrosion
- Outdoor Application
- Side Loading
- Other

Explain \_\_\_\_\_

### Functional Requirements

Compression Spring \_\_\_\_\_  
Tension Spring \_\_\_\_\_  
Initial Force (Newtons or pounds) \_\_\_\_\_  
Final Force (Newtons or pounds) \_\_\_\_\_  
Ambient Temperature Min/Max (°C or °F) \_\_\_\_\_  
Stroke Length Travel (mm or inches) \_\_\_\_\_  
Max Piston Rod Velocity (m/min or ft/min) \_\_\_\_\_  
Cycle Rate (cycles/min) \_\_\_\_\_

### Other Requirements

Lockable Feature  
 Monitoring Feature  
 Other  
Explain \_\_\_\_\_  
\_\_\_\_\_  
\_\_\_\_\_

# TECHNICAL SPECIFICATIONS

Model No.	S Stroke Length mm/in		L Length mm/in		ØA Tube Diameter mm/in		ØB Rod Diameter mm/in		ØC Mounting Diameter mm/in		
	mm	in	mm	in	mm	in	mm	in	mm	in	
CB750	-013	12.7	0.50	170.4	6.71	50.2	1.98	25.0	0.98	20.0	0.79
	-025	25.0	0.98	195.0	7.68						
	-038	38.1	1.50	221.2	8.71						
	-050	50.0	1.97	245.0	9.65						
	-064	63.5	2.50	272.0	10.71						
	-080	80.0	3.15	305.0	12.01						
	-100	100	3.94	345.0	13.58						
	-125	125	4.92	395.0	15.55						
	-160	160	6.30	465.0	18.31						
	-200	200	7.87	545.0	21.46						
	-250	250	9.84	645.0	25.39						
-300	300	11.81	745.0	29.33							
CB1500	-025	25.0	0.98	230.0	9.06	75.2	2.96	36.0	1.42	35.0	1.38
	-038	38.1	1.50	256.2	10.09						
	-050	50.0	1.97	280.0	11.02						
	-064	63.5	2.50	307.0	12.09						
	-080	80.0	3.15	340.0	13.39						
	-100	100	3.94	380.0	14.96						
	-125	125	4.92	430.0	16.93						
	-160	160	6.30	500.0	19.69						
	-200	200	7.87	580.0	22.83						
	-250	250	9.84	680.0	26.77						
	-300	300	11.81	780.0	30.71						
CB3000	-025	25.0	0.98	250.0	9.84	95.2	3.75	50.0	1.97	40.0	1.57
	-038	38.1	1.50	276.2	10.87						
	-050	50.0	1.97	300.0	11.81						
	-064	63.5	2.50	327.0	12.87						
	-080	80.0	3.15	360.0	14.17						
	-100	100	3.94	400.0	15.75						
	-125	125	4.92	450.0	17.72						
	-160	160	6.30	520.0	20.47						
	-200	200	7.87	600.0	23.62						
	-250	250	9.84	700.0	27.56						
	-300	300	11.81	800.0	31.50						
CB5000	-025	25.0	0.98	300.0	11.81	120.2	4.73	65.0	2.56	45.0	1.77
	-038	38.1	1.50	326.2	12.84						
	-050	50.0	1.97	350.0	13.78						
	-064	63.5	2.50	377.0	14.84						
	-080	80.0	3.15	410.0	16.14						
	-100	100	3.94	450.0	17.72						
	-125	125	4.92	500.0	19.69						
	-160	160	6.30	570.0	22.44						
	-200	200	7.87	650.0	25.59						
	-250	250	9.84	750.0	29.53						
	-300	300	11.81	850.0	33.47						

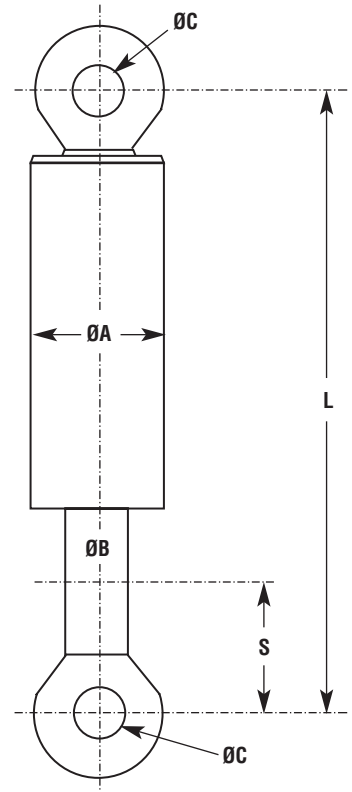

## Mounting Options

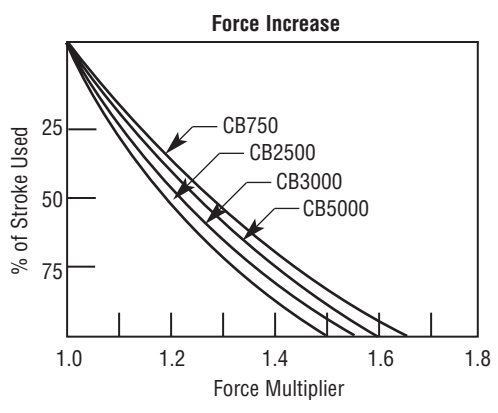
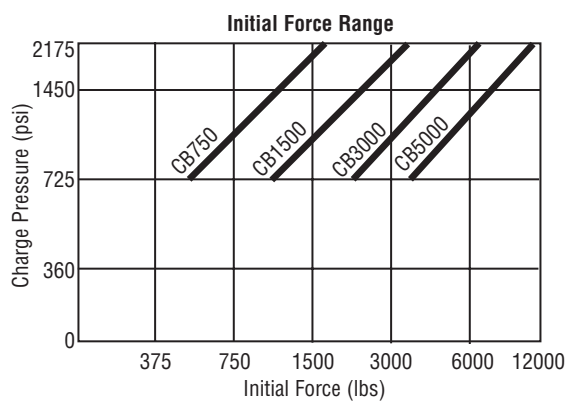
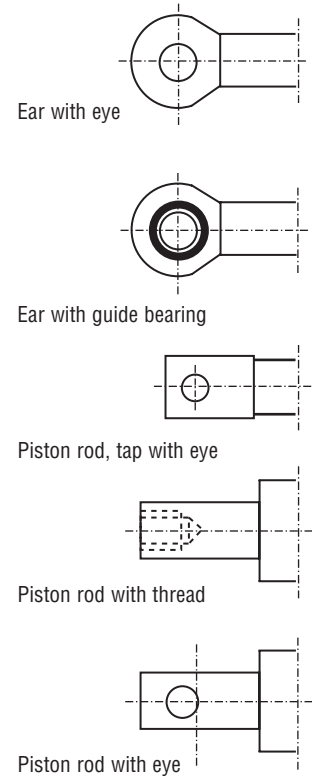

**Hyson™ Products**  
Associated Spring



**BASIC PRINCIPLES, DYNAMIC SOLUTIONS™**

©Hyson Products 2001  
CAS02012M

10367 Brecksville Road, Brecksville, OH 44141 • 1-800-876-4976 • Phone: 440-526-5900 • Fax: 440-838-7684  
Offices worldwide. For a listing of our global sales offices, visit our website at [www.hysonproducts.com](http://www.hysonproducts.com).